



GRILLS AND OUTDOOR KITCHEN PRODUCTS

KEY DEALER PRICE SHEET

Distributed by:



(573) 348-2130
Lake Ozark, MO 65049



LIMITED WARRANTY

Coyote Outdoor warrants to the original purchaser at the original site of delivery with proof of purchase of each Outdoor Gas grill/Side burner that when subject to normal residential use, it is free from defects in workmanship and materials for the periods specified below. This warranty excludes grills used in rental and commercial applications. This warranty excludes surface corrosion, scratches, and discoloration which may occur during regular use. It does NOT cover labor or labor related charges. There will be shipping and handling charge for the delivery of the warranty part(s).

<u>COMPONENT</u>	<u>WARRANTY PERIOD</u>
Cooking Grids (no rust or burn through)	5 years (limited)
Flavorizer Bars (no rust or burn through).....	2 years (limited)
Electric/Plastic Components	2 years (limited)
Ignition systems/Valves	1 year (limited)
Stainless steel frame/housing	Limited Lifetime
Stainless Steel Burners (no rust or burn through).....	Limited Lifetime

Our obligation under this warranty is limited to repair or replacement, at our option, of the product during the warranty period. The extent of any liability of Coyote under this warranty is limited to repair or replacement. This warranty does not cover normal wear of parts, damage resulting from any of the following: negligent use or misuse of the product, use on improper fuel/gas supply, use contrary to operating instructions, or alteration by any person other than a factory service center. The warranty period is not extended by such repair or replacement.

Please see Coyote Outdoor Living website at www.coyoteoutdoor.com for full warranty terms and conditions. This information is subject to change without notice. See website for most current information.

GRILLS

HERMES
COST

Model No. Description

C-SERIES

BUILT-IN GRILLS - 28"



- C-Series Grills include:**
- Premium stainless steel construction throughout
 - Stainless steel burners, grates and components
 - Double-walled stainless steel hood
 - Continuously welded grill bx with seamless edging,
 - Stainless steel warming rack and Heat Control Grids™
 - Interior grill lighting

New Model Numbers

C1C28LP	28" Built-In Grill with 640 sq. in. Grilling Area and 2-20,000 BTU Burners - LP	\$999.00
C1C28NG	28" Built-In Grill with 640 sq. in. Grilling Area and 2-20,000 BTU Burners - NG	\$999.00

BUILT-IN GRILLS - 34"



New Model Numbers

C1C34LP	34" Built-In Grill with 780 sq. in. Grilling Area and 3-20,000 BTU Burners - LP	\$1,299.00
C1C34NG	34" Built-In Grill with 780 sq. in. Grilling Area and 3-20,000 BTU Burners - NG	\$1,299.00

BUILT-IN GRILLS - 36"



New Model Numbers

C1C36LP	36" Built-In Grill with 875 sq. in. Grilling Area and 4-20,000 BTU Burners - LP	\$1,599.00
C1C36NG	36" Built-In Grill with 875 sq. in. Grilling Area and 4-20,000 BTU Burners - NG	\$1,599.00

GRILLS (CONTINUED)

HERMES
COST

Model No. Description

GRILL ON CART - 28"



New Model Numbers

C1C28LP-FS	28" Grill on Cart with 640 sq. in. Grilling Area and 2-20,000 BTU Burners - LP	\$1,199.00
C1C28NG-FS	28" Grill on Cart with 640 sq. in. Grilling Area and 2-20,000 BTU Burners - NG	\$1,199.00

C-SERIES CARTS



C1C28CT	Cart for 28" C1C28LP/NG Built-In Grill	New Model Number	\$499.00
C1C34CT	Cart for 34" C1C34LP/NG Built-In Grill	MODEL # CHANGE & SPECIAL PROMO PRICE	\$549.00
C1C36CT	Cart for 36" C1C36LP/NG Built-In Grill	MODEL # CHANGE & SPECIAL PROMO PRICE	\$599.00

C-SERIES ACCESSORIES

C1CSBLP	Single Side Burner for Carts - LP	NEW MODEL	\$599.00
C1CSBNG	Single Side Burner for Carts - NG	NEW MODEL	\$599.00
CJAKTCC2	Insulated Jacket for C1C28 28" Built-In Grill		\$479.00
CJAKTCC3	Insulated Jacket for C1C34 34" Built-In Grill		\$529.00
CJAKTCS36	Insulated Jacket for C1C36 36" Built-In Grill		\$539.00
CCVR2-BI	Vinyl Cover for C1C28 28" Built-In Grill		\$59.00
CCVR2-CT	Vinyl Cover for C1C28 28" Grill on Cart		\$99.00
CCVR3-BI	Vinyl Cover for C1C34 34" Built-In Grill		\$65.00
CCVR3-CT	Vinyl Cover for C1C24 34" Grill plus Cart		\$119.00
CCVR36-BI	Vinyl Cover for C1C36 36" Built-In Grill		\$65.00
CCVR36-CT	Vinyl Cover for C1C26 36" Grill plus Cart		\$119.00

GRILLS (CONTINUED)

Model No. Description

HERMES
COST

C-SERIES ACCESSORIES (CONTINUED)

CROTC2	Rotisserie Kit for C1C28 28" Grills	\$199.00
CROTC3	Rotisserie Kit for C1C34 34" Grills	\$199.00
CROTC36	Rotisserie Kit for C1C36 36" Grills	\$199.00
CSBX	Smoker Box	\$39.00
CGRDL	14" Heavy Duty Drop-In Griddle with Drip Tray	\$249.00
CLPREG	LP Regulator	\$39.00
CNGREG	NG Regulator	\$49.00
CWG28	Wind Guard for C1C28 and CC2X 28" Grills	\$35.00
CWG34	Wind Guard for C1C34 34" Grills	\$37.00
CWG36	Wind Guard for C1C63 36" Grills	\$39.00



S-SERIES BUILT-IN GRILLS



S-Series Grills include:

- Premium stainless steel construction throughout
- Stainless steel burners, grates and components
- Continuously welded grill box with seamless edging
- Double-walled stainless steel hood
- Stainless steel warming rack and Heat Control Grids,™
- **Infrared RapidSear™ Burner,**
- **Rear Infrared Rotisserie Burner,**
- **Interior grill lighting,**
- **Rotisserie Kit with Smoker box, and**
- **LED Backlit knobs.**

RED indicates upgrade over C-Series Grill.

BUILT-IN GRILLS - 36"



MODEL # CHANGES & SPECIAL PROMO PRICES

C1SL36LP	36" Built-In Grill with 875 sq. in. Grilling Area, <u>LED Knob Lights</u> & 95k Total BTU - LP	\$2,199.00
C1SL36NG	36" Built-In Grill with 875 sq. in. Grilling Area, <u>LED Knob Lights</u> & 95k Total BTU - NG	\$2,199.00

GRILLS (CONTINUED)

HERMES
COST

Model No. Description

BUILT-IN GRILLS - 42"



MODEL # CHANGES & SPECIAL PROMO PRICES

C1SL42LP	42" Built-In Grill with 1275 sq. in. Grilling Area, LED Knob Lights & 115k Total BTU - LP	\$2,999.00
C1SL42NG	42" Built-In Grill with 1275 sq. in. Grilling Area, LED Knob Lights & 115k Total BTU - NG	\$2,999.00

S-SERIES CARTS



C1S36CT	Cart for 36" C1S36LP/NG Built-In Grill	MODEL # CHANGES & SPECIAL PROMO PRICES	\$599.00
C1S42CT	Cart for 42" C1S42LP/NG Built-In Grill	MODEL # CHANGES & SPECIAL PROMO PRICES	\$799.00

S-SERIES ACCESSORIES

C1CSBLP	Single Side Burner for Carts - LP	NEW MODEL	\$599.00
C1CSB1G	Single Side Burner for Carts - NG	NEW MODEL	\$599.00
CJAKTCS36	Insulated Jacket for 36" C1S36LP/NG Built-In Grill		\$539.00
CJAKTCS42	Insulated Jacket for 42" C1S42LP/NG Built-In Grill		\$619.00
CCVR36-BI	Vinyl Cover for C1S36 36" Built-In Grill		\$65.00
CCVR36-CT	Vinyl Cover for C1S36 36" Grill plus Cart		\$119.00
CCVR42-BI	Vinyl Cover for C1S42 42" Built-In Grill		\$69.00
CCVR-42-CT	Vinyl Cover for C1S42 42" Grill plus Cart		\$139.00
CROTC36	Rotisserie Kit for C1S36 36" Grills		\$199.00
CROTC42	Rotisserie Kit for C1S42 42" Grills		\$199.00
CSBX	Smoker Box		\$39.00
CGRDL	14" Heavy Duty Drop-In Griddle with Drip Tray		\$249.00
CLPREG	LP Regulator		\$39.00
CNGREG	NG Regulator		\$49.00
CWG36	Wind Guard for C1S36 36" Grills		\$39.00
CWG42	Wind Guard for C1S42 42" Grills		\$44.00



GRILLS (CONTINUED)

Model No. Description

HERMES
COST

HYBRID GRILLS

BUILT-IN HYBRID GAS / CHARCOAL GRILL

Hybrid Grill includes:

- Premium stainless steel construction throughout
- Stainless grates, components and warming rack
- Double-walled stainless steel hood
- Continuously welded grill box with seamless edging

Charcoal Grill includes:

- Adjustable fuel tray
- Over 600 sq. in. grill area
- Use charcoal and/or wood chips
- Adjustable dampers control air flow/temp
- Removable tray for easy cleanup

Gas Grill includes:

- 2-20k BTU stainless iBurners™
- High performance Heat Control Grids
- Over 600 sq. in. grill area
- Interior lighting



New Model Numbers

C1HY50LP	50" Built-In Hybrid Grill with 1200 sq. in. Grilling Area - Charcoal and LP	\$2,999.00
C1HY50NG	50" Built-In Hybrid Grill with 1200 sq. in. Grilling Area - Charcoal and NG	\$2,999.00
C1CH36	36" Charcoal Grill NEW MODEL	\$1,599.00

HYBRID CARTS

C1HY50CT CART FOR 50" HYBRID GRILL
IMAGE NOT AVIALBLE.

C1HY50CT	Cart for 50" C1HY50LP/NG Built-In Hybrid Grill	MODEL # CHANGES / SPECIAL PROMO	\$849.00
C1CH36CT	Cart for 36" C1CH36 Built-In Charcoal Grill	NEW MODEL	\$599.00

HYBRID ACCESSORIES

C1CSBLP	Single Side Burner for Carts - LP	NEW MODEL	\$599.00
C1CSB1G	Single Side Burner for Carts - NG	NEW MODEL	\$599.00
CCVR50-BI	Vinyl Cover for C1HY50 50" Built-In Hybrid Grill		\$79.00
CCVR50-CT	Vinyl Cover for C1HY50 50" Hybrid Grill plus Cart		\$149.00
CCVR36-BI	Vinyl Cover for C1CH36 Built-In Charcoal Grill		\$65.00
CCVR36-CT	Vinyl Cover for C1CH36 Charcoal Grill plus Cart		\$119.00
CSBX	Smoker Box		\$35.00
CGRDL	14" Heavy Duty Drop-In Griddle with Drip Tray		\$249.00
CLPREG	LP Regulator		\$39.00
CNGREG	NG Regulator		\$49.00
CROTC36	Rotisserie Kit for C1CH36 Charcoal Grill		\$199.00



ASADO SMOKER

ALL NEW PRODUCT LINE for Coyote

HERMES
COST

Model No. Description

ASADO SMOKERS Include:

- Coyote Signature Smoking Grate™
- Heat-resistant ceramic construction
- 254 sq. in. of cooking area
- Adjustable venting to maintain precise cooking temperatures
- Smoke, sear or grill options
- Built-In or Cart (with side shelves) models



- C1CHCS** Asado Smoker
- C1CHCS-FS** Asado Smoker with Stand and Side Shelves
- C1CHCS-CT** Asado Smoker STAND and SIDE SHELVES ONLY

*Anticipated
availability - June
2016.*

\$999.00
\$1,199.00
\$199.00

GRILLING ACCESSORIES

HERMES
COST

Model No. Description

POWER BURNERS



Power Burner includes:

- Premium Stainless Steel construction throughout
- Dual valve burner with up to 60k BTU
- Simmer down to 1,000 BTU
- Includes stainless steel cover
- Optional Teppanyaki griddle and Wok available

- C1PBLP** Power Burner - LP
- C1PBNG** Power Burner - NG

New Model Numbers

\$1,099.00
\$1,099.00

POWER BURNER ACCESSORIES

- CTEP** Teppanyaki Griddle for CPB Power Burner
- CWOK** Wok Accessory for CPB Power Burner



\$399.00
\$99.00

SIDE BURNERS

New Model Numbers

- C1SBLP** Single 15k BTU Stainless Side Burner unit with Brass Burner and Stainless Cover - LP
- C1SBNG** Single 15k BTU Stainless Side Burner unit with Brass Burner and Stainless Cover - NG
- C1DBLP** Dual 15k BTU Stainless Side Burner unit with Brass Burners and Stainless Cover - LP
- C1DBNG** Dual 15k BTU Stainless Side Burner unit with Brass Burners and Stainless Cover - NG



\$399.00
\$399.00
\$699.00
\$699.00

GRILLING ACCESSORIES (CONTINUED)

HERMES
COST

Model No.	Description		HERMES COST
C1CSBLP	Single Side Burner for Carts - LP	NEW MODELS	\$599.00
C1CSBNG	Single Side Burner for Carts - NG		\$599.00
CCVRSB-BI	Vinyl Cover for CSSB Single Side Burner		\$39.00
CCVRDB-BI	Vinyl Cover for CDSB Double Side Burner		#39.00

SIGNATURE GRATES (3-Pack)

CSIGRATE15	Signature Grates for C1C28 and C1SL42 Grills	NEW MODELS	\$299.00
CSGRATE12	Signature Grates for C1C34 and C1SL36 Grills		\$299.00

CHARCOAL TRAYS (1-piece)

CCHTRAY15	Charcoal Trays for C1C28 and C1SL42 Grills	NEW MODELS	\$99.00
CCHTRAY12	Charcoal Trays for C1C34 and C1SL36 Grills		\$99.00

MISCELLANEOUS GRILLING ACCESSORIES

CWD	30" Premium Stainless Steel Warming Drawer - 110 V		\$1,199.00
CSBX	Smoker Box		\$39.00
CGRDL	14" Heavy Duty Drop-In Griddle with Drip Tray		\$249.00

STORAGE COMPONENTS

HERMES
COST

Model No. Description

ACCESS DOORS



CDA2426	26" Double Access Door	<p>Access Doors include:</p> <ul style="list-style-type: none"> ▪ Premium Stainless Steel throughout ▪ Stainless Pro Style Handles ▪ Beveled trim. 	\$239.00
CDA2431	31" Double Access Door		\$279.00
CDA2439	39" Double Access Door		\$299.00
CSA1420	Single Access Door - 14" x 20"		\$189.00
CSA1724	Single Access Door - 17" x 24"		\$229.00
CSA2014	Single Access Door - 20" x 14"		\$189.00
CSA2417	Single Access Door - 24" x 17"	\$229.00	

DRAWERS



C2DC	2-Drawer Stainless Cabinet	<p>Cabinets and Drawers include:</p> <ul style="list-style-type: none"> ▪ Premium Stainless Steel throughout ▪ Stainless Pro Style Handles ▪ Beveled trim ▪ Easy open roller glides. 	\$459.00
C3DC	3-Drawer Stainless Cabinet		\$499.00
CPOD	Pull-Out Drawer (Trash, LP Tank)		\$319.00
CPH	Paper Towel Holder		\$119.00
CSSD	Single Storage Drawer		\$479.00

COMBO DOORS / DRAWERS

Cabinets and Drawers include:

- Premium Stainless Steel
- Stainless Pro Style Handles
- Beveled trim
- Easy open roller glides (drawers)



CCD-POD	44" Pull-Out Drawer / Double Door Combo	\$549.00
CCD-2DC	44" Double Drawer / Double Door Combo	\$649.00
CCD-WD	41" Warming Drawer / Single Drawer / Single Door Combo	\$1,499.00

CCD-2DC31	31" Combo Door and Drawer	<p>NEW MODEL</p> <p>NEW MODEL</p> <p>NEW MODEL</p>	\$649.00
CDPC31	31" Dry Pantry		\$899.00
CTC	Pull-Out Trash and Recycle		\$549.00



REFRIGERATION AND REFRESHMENT

HERMES
COST

Model No. Description

REFRIGERATORS



- Outdoor Refrigerator:**
- Stainless Steel exterior with Pro handles
 - Auto Defrost
 - 4.1 cu. ft.
 - Interior light & adjustable thermostat
 - Specify Right or Left Hinge



CBIR-R 21" Built-In Outdoor Undercounter Refrigerator - Stainless (Right Hinge)
CBIR-L 21" Built-In Outdoor Undercounter Refrigerator - Stainless (Left Hinge)

~~\$1,099.00~~
\$1,099.00

C1BIR24-R 24" Built-In Outdoor Undercounter Refrigerator - Stainless (Right Hinge)
C1BIR24-L 24" Built-In Outdoor Undercounter Refrigerator - Stainless (Left Hinge)

NEW MODEL
NEW MODEL

\$1,499.00
\$1,499.00

COOLERS AND ICE CHESTS



- Drop-In Cooler:**
- Stainless Steel construction,
 - Hinged, stainless steel lid with seal,
 - Fully insulated, and
 - Drain and Beveled Trim.

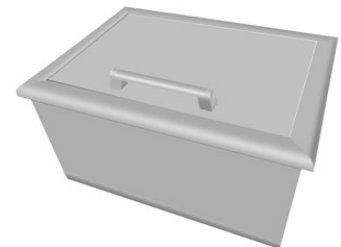

CDIC 24" Drop-In Stainless Cooler
CPOC Pull-Out Ice Chest

NEW MODEL

\$399.00
\$699.00

SINK / REFRESHMENT CENTER



- Refreshment Center:**
- Premium Stainless Steel construction
 - Sink and faucet
 - Drop-In Cooler with drain
 - Removable condiment tray,
 - Speed Rail, towel holder, bottle opener, and cutting board.

CRC 30" Refreshment Center

\$1,199.00

All Electrical Transformers plug into the grill behind the control panel on the left side, if you are looking at the grill from the front.

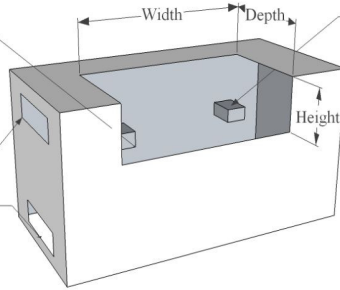

All Gas Line Connection are at the rear bottom right of the grill, if you are looking at the grill from the front.

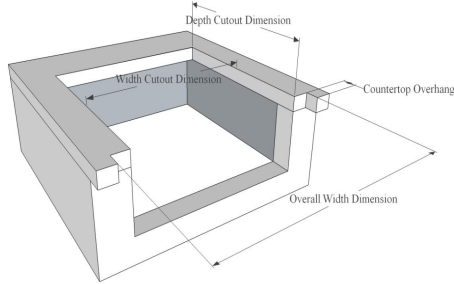

Ventilation of Island:

- *Minimum of 2 vents for an island.
- *Each vent must be at least 20 sq in.
- *Alternate sides of the island is preferred for cross-ventilation.
- *See Owners Manual for full details

Clearance to Combustible Construction:
When choosing a location for your gas grill, you should not locate it under any combustible construction. The side, bottom, and back of the grill should not be any closer than 24" to combustible material.

Model	Product Description	Cutout Dimensions			Overall Dimensions			Total BTU Ratings		Electrical Outlets Needed (110V)	
		Height	Width	Depth	Height	Width	Depth	LP	NG	Rotisserie	Lights
Grills											
CCX2	28" Grill w/ Hood Lights	10 1/4"	25"	20 1/2"	23"	28"	25 1/2"	40,000	40,000	No	Qty 1
C1C28	28" Grill w/ Hood Lights	10 1/4"	26 3/8"	20 1/2"	23"	28"	25 1/2"	40,000	40,000	No	Qty 1
CC(X)3 / C1C34	34" Grill w/ Hood Lights	10 1/4"	31"	20 1/2"	23"	34"	25 1/2"	60,000	60,000	No	Qty 1
CCX4 / C1C36	36" Grill w/ Hood Lights	10 1/4"	32 1/2"	20 1/2"	23"	35 1/2"	25 1/2"	80,000	80,000	No	Qty 1
CS(X)36 / C1S36	36" Grill w/ Hood Lights & Rotis	10 1/4"	32 1/2"	20 1/2"	23"	35 1/2"	25 1/2"	90,000	90,000	Qty 1	Qty 1
CSL(X)36 / C1SL36	36" Grill w/ Hood & LED Lights	10 1/4"	32 1/2"	20 1/2"	23"	35 1/2"	25 1/2"	90,000	90,000	Qty 1	Qty 1
CSL(X)42 / C1SL42	42" Grill w/ Hood & LED Lights	10 1/4"	39 1/2"	20 1/2"	23"	42"	25 1/2"	110,000	110,000	Qty 1	Qty 1
CH(X)50 / C1HY50	50" Hybrid Grill w/ Hood Lights	12 1/2"	47 3/4"	20 1/2"	23"	50"	25 1/2"	40,000	40,000	No	Qty 1
C1CH36	36" Charcoal Grill	12 1/2"	32 1/2"	20 1/2"	23"	35 1/2"	25 1/2"	N/A	N/A	No	No
Side Burners											
CSSB(X) / C1SB	Coyote Single Side Burner	10 1/4"	10 1/8"	13 5/8"	13"	11 3/8"	17"	15,000	15,000	No	No
CDSB(X) / C1DB	Coyote Dual Side Burner	10 1/4"	11 7/8"	20 1/4"	13"	13 1/8"	23 1/4"	30,000	30,000	No	No
CPB / C1PB	Coyote Power Burner	10 1/4"	20 1/2"	21"	13"	24"	24 1/4"	60,000	60,000	No	No
Insulated Jackets											
CJAKTC2	Insulated Jacket for 28" Grills	11"	28 1/4"	21 3/4"	11"	30 3/4"	22 1/4"	For Combustible Construction			
CJAKTC3	Insulated Jacket for 34" Grills	11"	34 1/4"	21 3/4"	11"	36 3/4"	22 1/4"	For Combustible Construction			
CJAKTC36	Insulated Jacket for 36" Grills	11"	35 3/4"	21 3/4"	11"	38 1/4"	22 1/4"	For Combustible Construction			
CJAKTC42	Insulated Jacket for 42" Grills	11"	42 1/2"	21 3/4"	11"	45"	22 1/4"	For Combustible Construction			
Access Doors											
CDA2426	26" Double Access Door	20 1/2"	20 3/4"	N/A	24"	24 1/4"	3"	N/A			
CDA2431	31" Double Access Door	20 1/2"	26 1/2"	N/A	24"	30"	3"	N/A			
CDA2439	39" Double Access Door	20 1/2"	34 1/2"	N/A	24"	38"	3"	N/A			
CSA2014	Single Access Door 20" x 14"	20 1/2"	14 1/2"	N/A	22"	16"	3"	N/A			
CSA1420	Single Access Door 14" x 20"	14 1/2"	20 1/2"	N/A	16"	22"	3"	N/A			
CSA2417	Single Access Door 24" x 17"	24 1/2"	17 1/2"	N/A	26"	19"	3"	N/A			
CSA1724	Single Access Door 17" x 24"	17 1/2"	24 1/2"	N/A	19"	26"	3"	N/A			
Drawers											
C2DC	2 Drawer Cabinet	20 1/2"	14 1/2"	17 1/2"	22"	16 1/4"	18"	N/A			
C3DC	3 Drawer Cabinet	24 1/2"	16 3/4"	17 1/4"	26"	18 1/2"	18"	N/A			
CSSD	Single Storage Drawer	13 1/2"	31 1/2"	20 1/2"	15"	32 1/2"	21 1/4"	N/A			
CDPC31	31" Dry Pantry	20 1/2"	26 1/2"	23"	24"	30"	24"	N/A			
CTC	Pull Out Trash & Recycle	23 7/8"	23 3/4"	18"	26 1/4"	26 3/4"	19"	N/A			
CPOD	LP Tank or Trash Drawer	20 1/2"	14 1/4"	17 1/2"	22"	15 1/2"	18"	N/A			
CPTH	Paper Towel Holder	8 1/4"	13 1/2"	8"	10"	15"	9"	N/A			
CWD	Warming Drawer	9 1/2"	28 1/4"	23 1/2"	10 3/4"	29 1/2"	26 3/4"	Qty 1 Plug Needed - unit is 450 Watt			
Combo Drawers											
CCD-2DC	Double Drawer Combo	20 1/4"	43 3/8"	17 1/8"	24 1/8"	45 1/4"	18 3/8"	N/A			
CCD-2DC31	31" Double Drawer Combo	20 1/2"	26 1/2"	20 1/8"	24"	30"	21 1/8"	N/A			
CCD-POD	Pull Out Drawer Combo	20 3/8"	43 3/8"	16 1/4"	24 1/8"	45 1/4"	17 1/2"	N/A			
CCD-WD	Warming Drawer Combo	19 1/2"	40 5/8"	25 1/4"	20 3/4"	42 1/8"	26 1/2"	Qty 1 Plug Needed - unit is 450 Watt			
Refrigeration & Refreshment Centers											
CBIR	4.1 Outdoor Refrigerator	34"	20 3/4"	23"	33 3/4"	20 1/2"	22 3/4"	Qty 1 Plug Needed - Vented Bottom Front			
C1BIR24	5.5 Outdoor Refrigerator	33 1/4"	23 3/4"	22 3/4"	33"	23 1/2"	22 1/2"	Qty 1 Plug Needed - Vented Bottom Front			
CDIC	Drop In Cooler	12"	23 1/4"	17 1/4"	15"	24 1/2"	18"	Can be turned in either direction			
CPOC	Pull Out Ice Chest	17 1/2"	23 3/4"	24 3/4"	20 1/2"	26 3/4"	25 1/2"	Additional support for weight needed			
CRC	Refreshment Center	10"	29 1/4"	22 3/4"	10 3/4"	30 1/4"	29"	Drain Hose Included			

Cutout Dimensions: Build your bbq island to these specifications to ensure proper fit of the product being used.
Overall Dimensions: Describe the actual dimensions of the product once it is resting/installed in a bbq island.
Clearance to Combustibles: The dimensions required by the manufacturer for clearance to combustible materials.
Total BTU Ratings: These numbers show the total volume of gas used by the product while operating at full capacity.

Important Note to Consumer: This is not intended to replace your Owners' Manual which contains specific safety requirements and consumer guidelines. Please refer to your Owners' Manual prior to installing or operating your built-in bbq. All grills listed are intended for outdoor use only and are not intended to be installed in or on recreational vehicles or boats.

Questions? Visit our website at www.coyoteoutdoor.com

COYOTE

ISLAND CUTOUT DIMENSIONS

Ventilation of the Island:

- * A minimum of two vents, of at least 20 sq in per vent must be located on an outdoor kitchen that has any Coyote Grill or Sideburner
- * The ventilation of the island will allow your Coyote product to receive the air needed for combustion, proper use and the expulsion of heat from the island.
- * You must also check your county codes to ensure you are within proper guidelines for your location
- * Always refer to your owners manual for full ventilation information

Installation of Equipment:

- * All grills and sideburners come with the necessary regulator only. Any further hook-up pieces (shut-off valves, nipples, tees, etc) must be procured and purchased separately, as each install is unique to the job.
- * All grills and side burners rest on their own frame and do not need to be supported from underneath.
- * All combo drawer pieces are rather heavy and to protect your island, you will want to create a support underneath the cabinet. There are no support brackets or likewise available through Coyote, as these will vary depending on your application.
- * For the doors and drawers you will need to acquire your own screws and/or appropriate anchors, as these too are unique to each job and will vary drastically depending on your building material.

Clearance to Combustibles for all Gas Related Products is 24" unless, an authorized Coyote Insulated Jacket is used for the install.

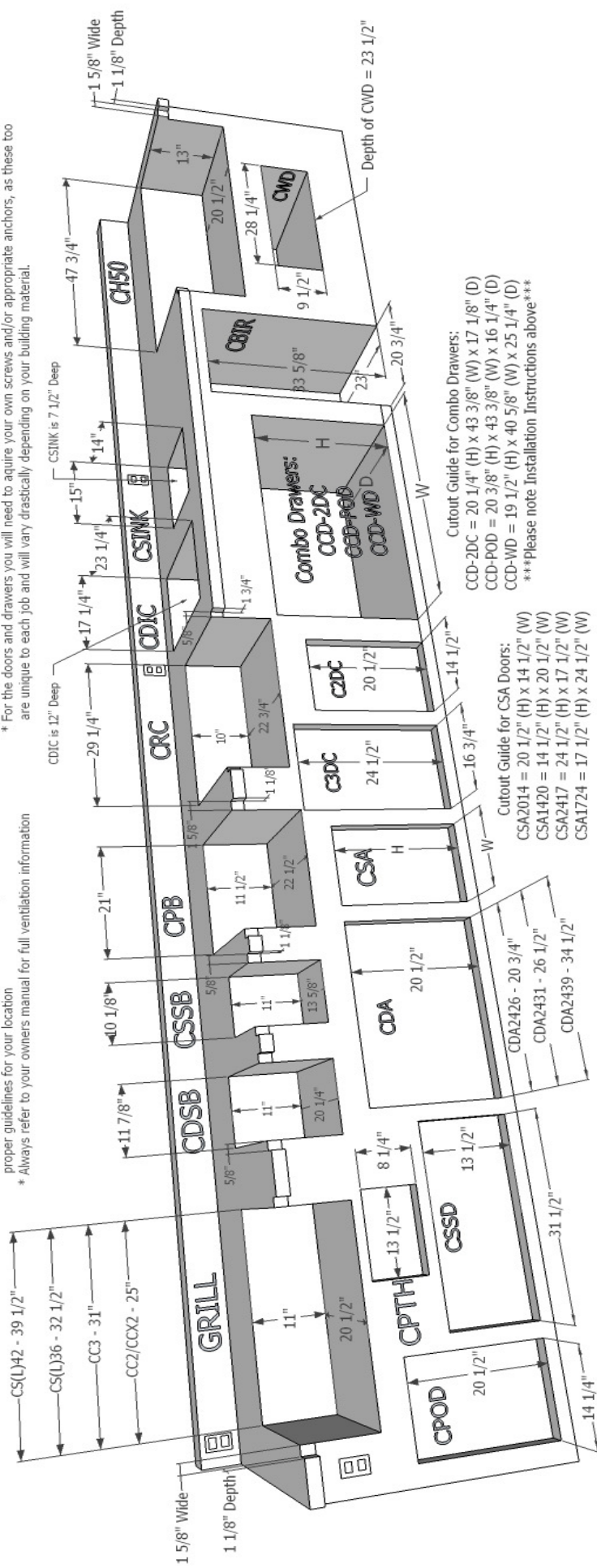

Cutout Guide for Combo Drawers:

- CCD-2DC = 20 1/4" (H) x 43 3/8" (W) x 17 1/8" (D)
- CCD-POD = 20 3/8" (H) x 43 3/8" (W) x 16 1/4" (D)
- CCD-WD = 19 1/2" (H) x 40 5/8" (W) x 25 1/4" (D)

Please note Installation Instructions above

Cutout Guide for CSA Doors:

- CSA2014 = 20 1/2" (H) x 14 1/2" (W)
- CSA1420 = 14 1/2" (H) x 20 1/2" (W)
- CSA2417 = 24 1/2" (H) x 17 1/2" (W)
- CSA1724 = 17 1/2" (H) x 24 1/2" (W)

This "flysheet" only shows the cutout dimensions needed for Coyote product. It does not show overall product dimensions. Always refer to your owners manual before operating your grill for specific safety instructions and consumer guidelines.

For the constant advancement of our products, Coyote Outdoor reserves the right to change the specifications, designs and materials of the product without prior notification.



Warranty, Installation Instructions and Care and Use Manuals are available on the Coyote website: www.coyoteoutdoor.com.